

Bondura Multi Tool - Cone Puller

Type: BMT – HY - 140

For Bondura diameter $\varnothing 70 - \varnothing 200\text{mm}$



The disassembly multi tool fit up to:

Cone for Bondura 6.6

Cone for Bondura 6.1

Cone for Bondura 66.66



Loosen the bolt and remove the locking plate

The bolt must be completely loosened so that neither the bolt nor the taper sleeve bears on the support. The screws/ locking plate are then removed. The taper sleeves have exterior flanges for attaching to the Bondura Multi Tools Jaw (pos.3).



Attach puller

The withdrawal tool with adjustable jaws is fitted around the cone flange.

Bondura Multi Tool - Bolt Puller

Type: BMT – HY - 140.

For Bondura diameter $\varnothing 70 - \varnothing 200\text{mm}$

The disassembly multi tools fit up to:

Bondura 3.3

Bondura 6.6

Bondura 6.1

Bondura 66.66

Bondura 36.36

NB! The cones / taper sleeves must be disassembled before pulling out the bolt.



A adapter plate is mounted onto the bolt

Once the cone/taper sleeve has been removed, the adapter plate (pos.14) has to be fastened with screws onto the bolt.



Different types

of adapters plates fits for separately Bondura types. An adapter holder (pos.13) mounted outside the adapter plate.



Mount the thread rod (pos. 10) to the adapter holder.



Mount the hydraulic puller to the casing.

NB!

The piston extension (pos.4) of the hydraulic puller should be turned away from the Bondura bolt..



The puller is assembled. For extremely stuck bolts, contact Bolt Norge for a high performance Bolt Puller (90ton)

Bondura Multi Tool - BMT-HY-140

Cone and bolt puller for Bondura diameter $\varnothing 70 - 200\text{mm}$

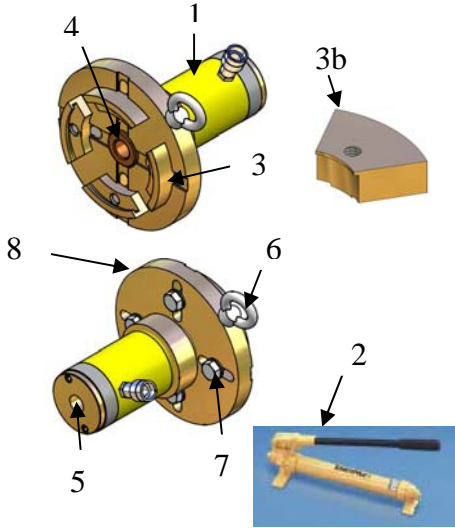

Cone puller designation

Position	Description	Item no	Content	Pieces
Pos 1:	Hydraulic puller 30ton	101473	1 pcs	<input type="checkbox"/>
Pos 2a:	Pump + manometer	102509	1 pcs	<input type="checkbox"/>
Pos 2b:	Hydraulic hose	101472	1 pcs	<input type="checkbox"/>
Pos 3:	Jaw M20 sett 140-200	101567	4 pcs	<input type="checkbox"/>
Pos 3b:	Jaw M20 sett 70-130	101772	4 pcs	<input type="checkbox"/>
Pos 4:	Piston extension	101381	1 pcs	<input type="checkbox"/>
Pos 6:	Lifting eye M16	101486	1 pcs	<input type="checkbox"/>
Pos 7:	Screws M20x50	100073	4 pcs	<input type="checkbox"/>
Pos 8:	Pulling plate 140	101568	1 pcs	<input type="checkbox"/>

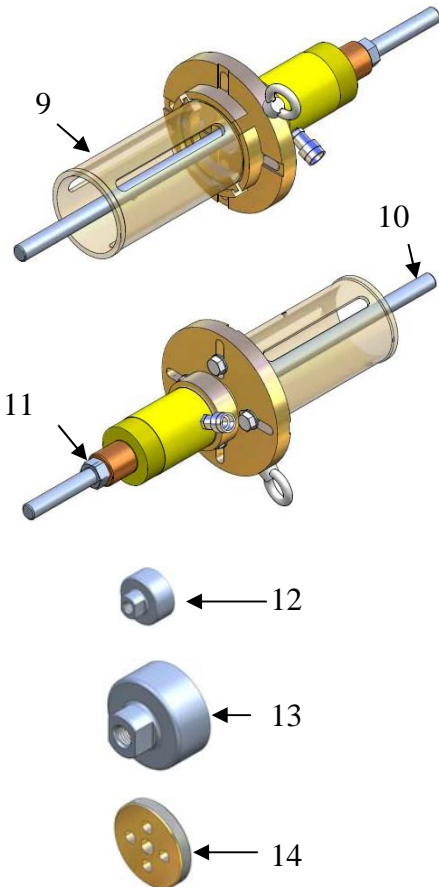

Bondura bolt puller designation

Position	Description	Item no	Content
Pos 5:	Puller fastener plate	101497	1 pcs
Pos 9:	Casing - $\varnothing 140$	101492	1 pcs
	Casing - $\varnothing 200$	101491	1 pcs
Pos 10:	Thread rod M30	101331	1 pcs
Pos 11:	Nut M30	101494	1 pcs

Adapters

Position	Description	Item no
Adapter for Bondura 3.3		
Pos 12a:	M36 for 52-70	101801
Pos 12b:	M42 for 72-90	101802
Pos 12c:	M56 for 92-130	101803
Adapter for Bondura 6.6		
Pos 13:	Holder for 70-130	101498
Pos 14a:	70-80	101507
Pos 14b:	85-95	101501
Pos 14c:	100-110	101500
Pos 14d:	114-130	101499

.....
date of delivery / signature